

WITH THE PADDLE TO THE FACULTY AND BACK

AUTORSKÝ TÝM:
JAN GERITS
JOHANA KREJČÍ
MARIETA MALÍKOVÁ
MARKÉTA MALÍNKOVÁ
EVA TRUNCOVÁ



IN NOVEMBER 2016 WE TOOK A PART IN THE WORKSHOP IN OLOMOUC. THE MAIN TOPIC WERE SCHOOLS AND THEIR COURTYARDS. AFTER THE EXCURSION WE DECIDED TO ANALYSE ŽIŽKOVO SQUARE WITH ITS PEDAGOGICAL FACULTY AND TRY TO FIND A SOLUTION FOR THIS IMPORTANT PLACE IN OLOMOUC.

PARTS OF THIS DOCUMENTATIONS ARE:

1. PROS AND CONS - THE MAIN POSITIVE AND NEGATIVE FACILITIES OF THIS AREA
2. PLACE VS. TOWN - CHARACTER OF THE TOWN AND THE SMALL PART OF IT
3. REALITY VS. VISION - OUR CONCEPT

Ideový návrh studentů Ústavu experimentální tvorby byl vytvořen v rámci dvoudenního workshopu v listopadu 2016.

PROS VS. CONS

PROS

POSITIVE ELEMENTS OF THE SQUARE

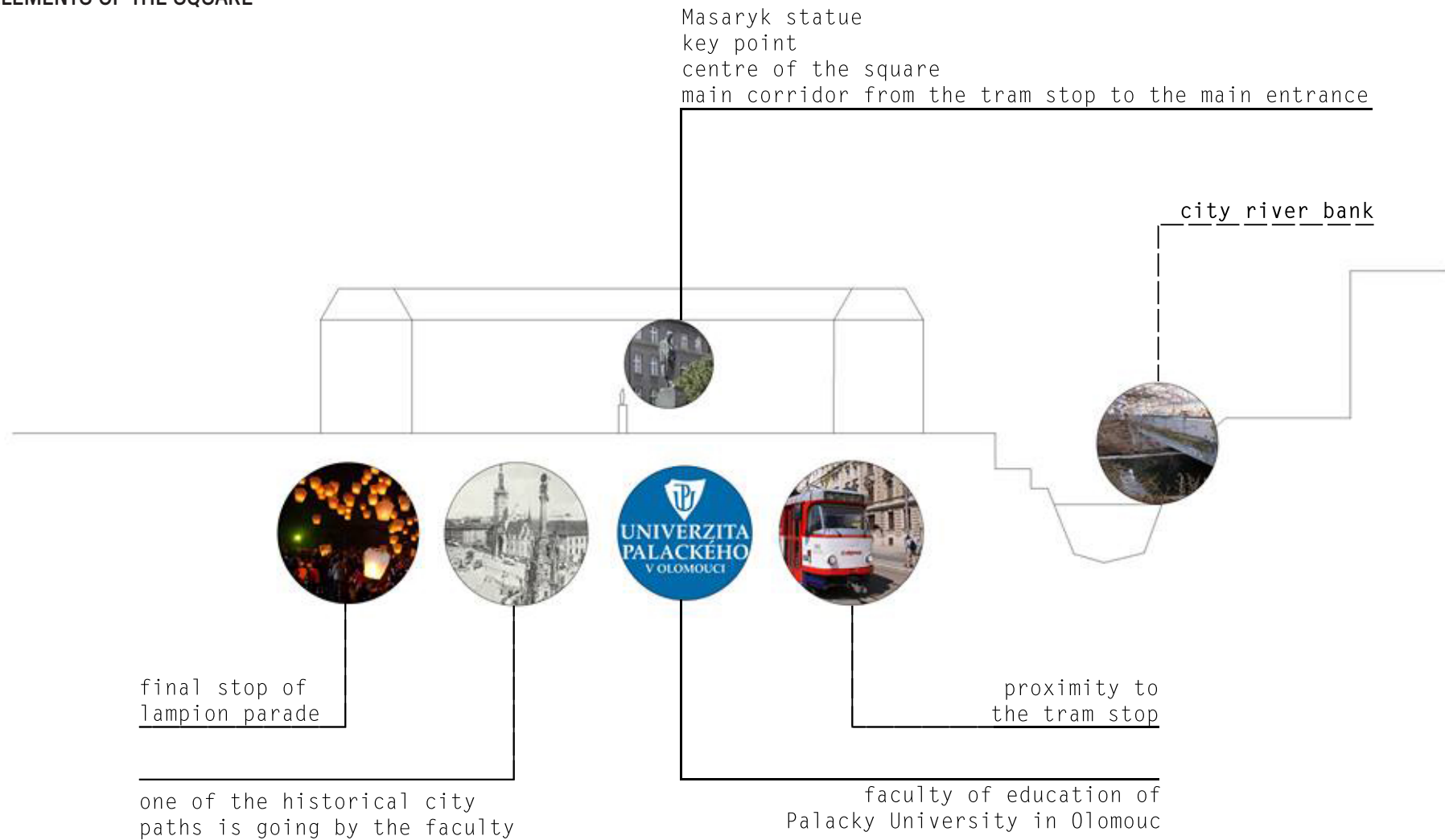



Masaryk statue is one of the key points of Olomouc

PROS VS. CONS

CONS

NEGATIVE ELEMENTS OF THE SQUARE

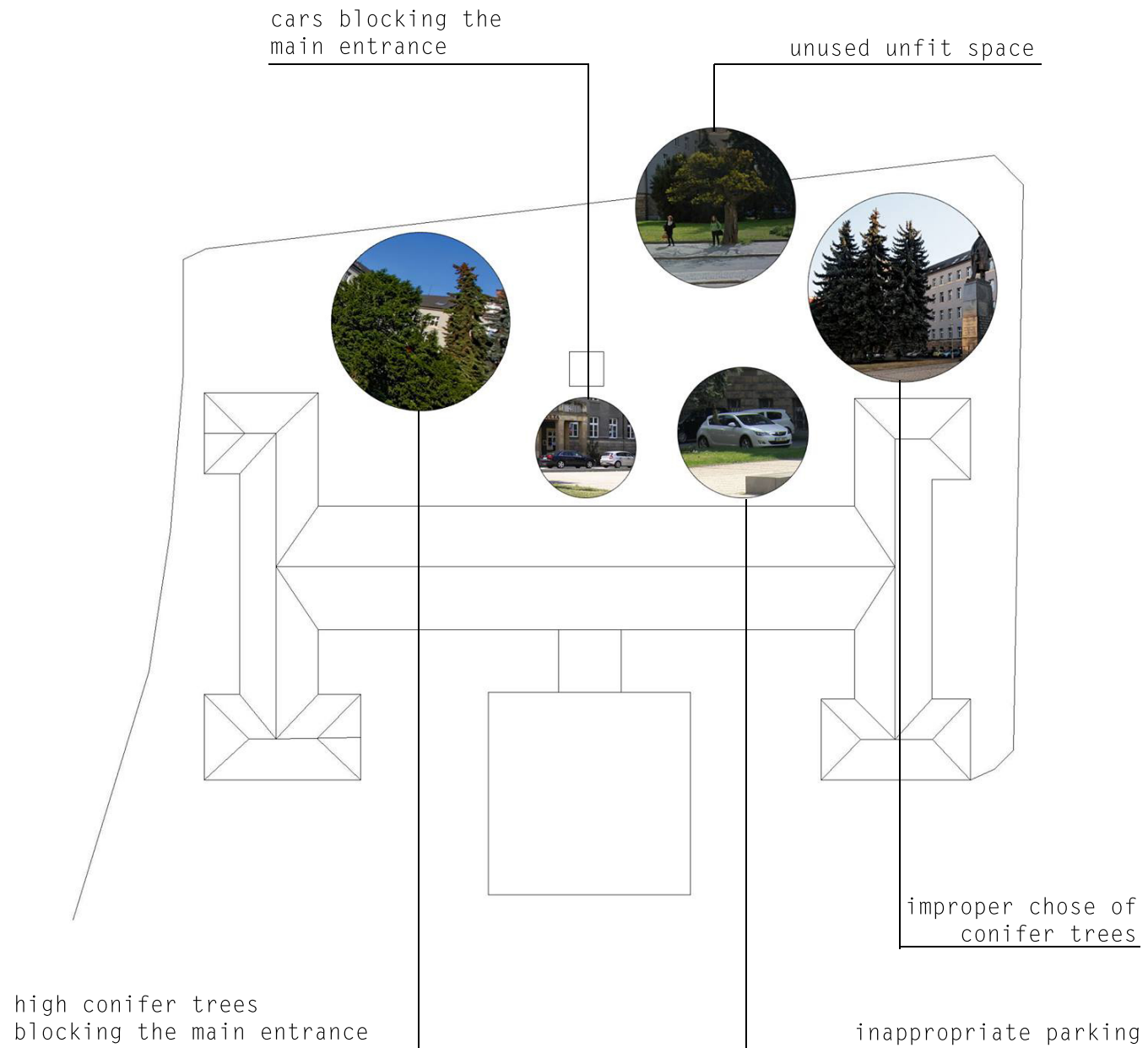





PLACE VS. TOWN

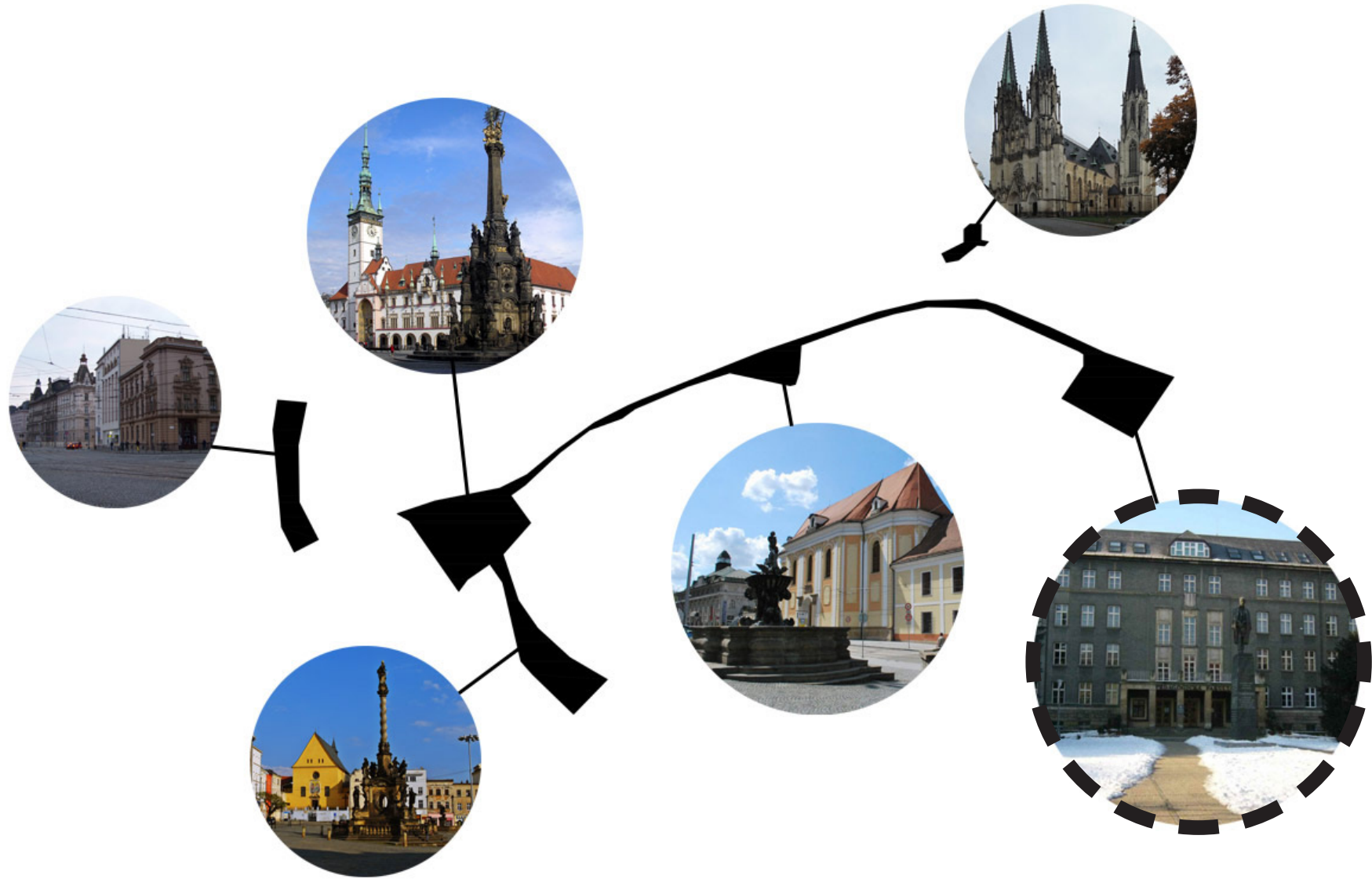

Picture analysis shows the typical nature of squares in Olomouc. Square with the Masaryk statue is in a strong contrast with this nature.

REALITY VS. VISION

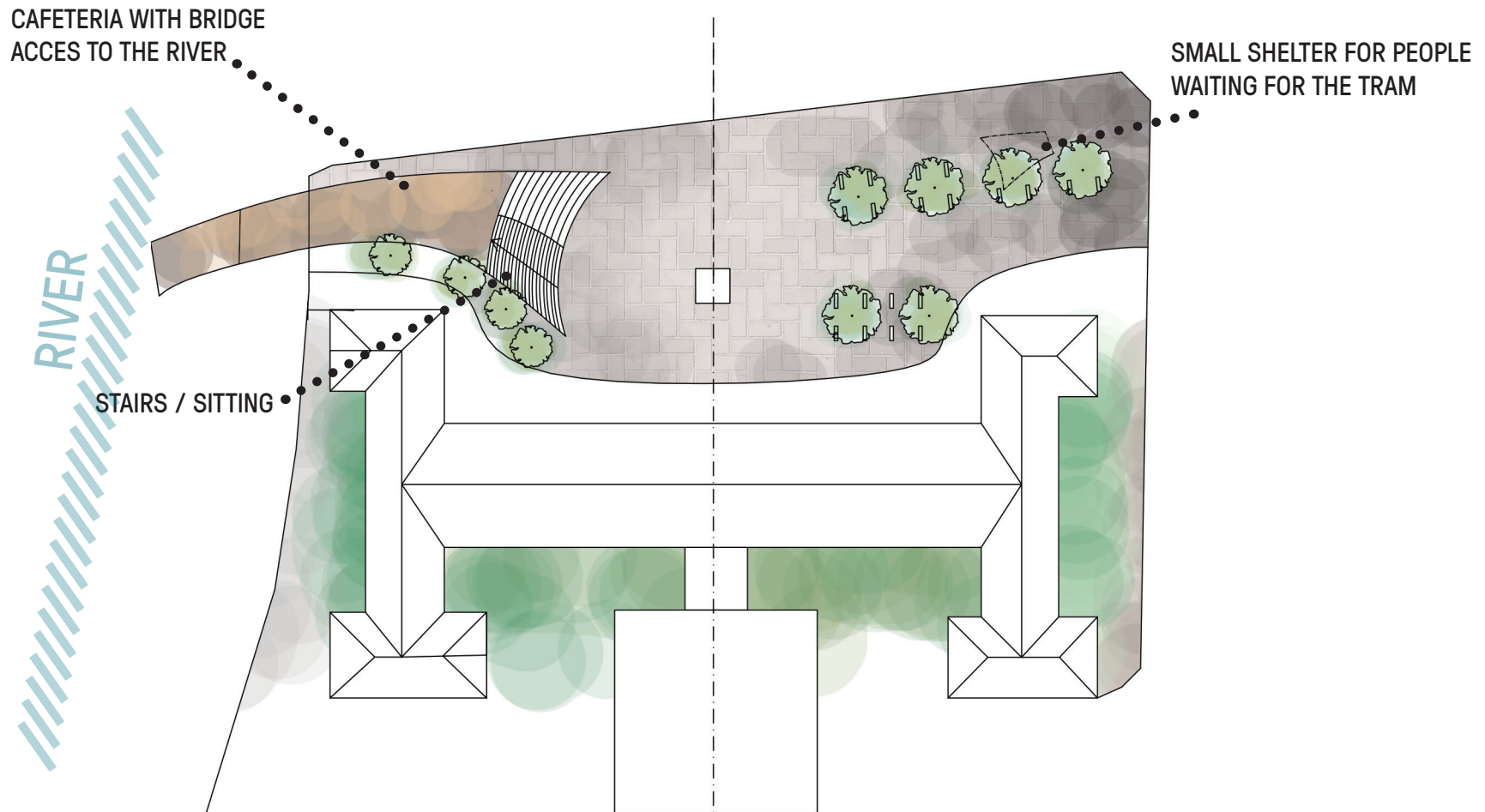

As the main topic for our concept we took the connection with the river nearby. Because of the way between the faculty and the river we chose the possibility to reach the river through the bridge. This connection to nature is showed by the organic form. As a contrast in the other part of the square we decided to make only clear sittings with new green alley. Shelter for people, who wait for the tram, again, is made in simple organic form, as a small "memento" of the square's character. The whole square is made in simple symmetry, the main centre stays in the middle - right where the Masaryk statue is.

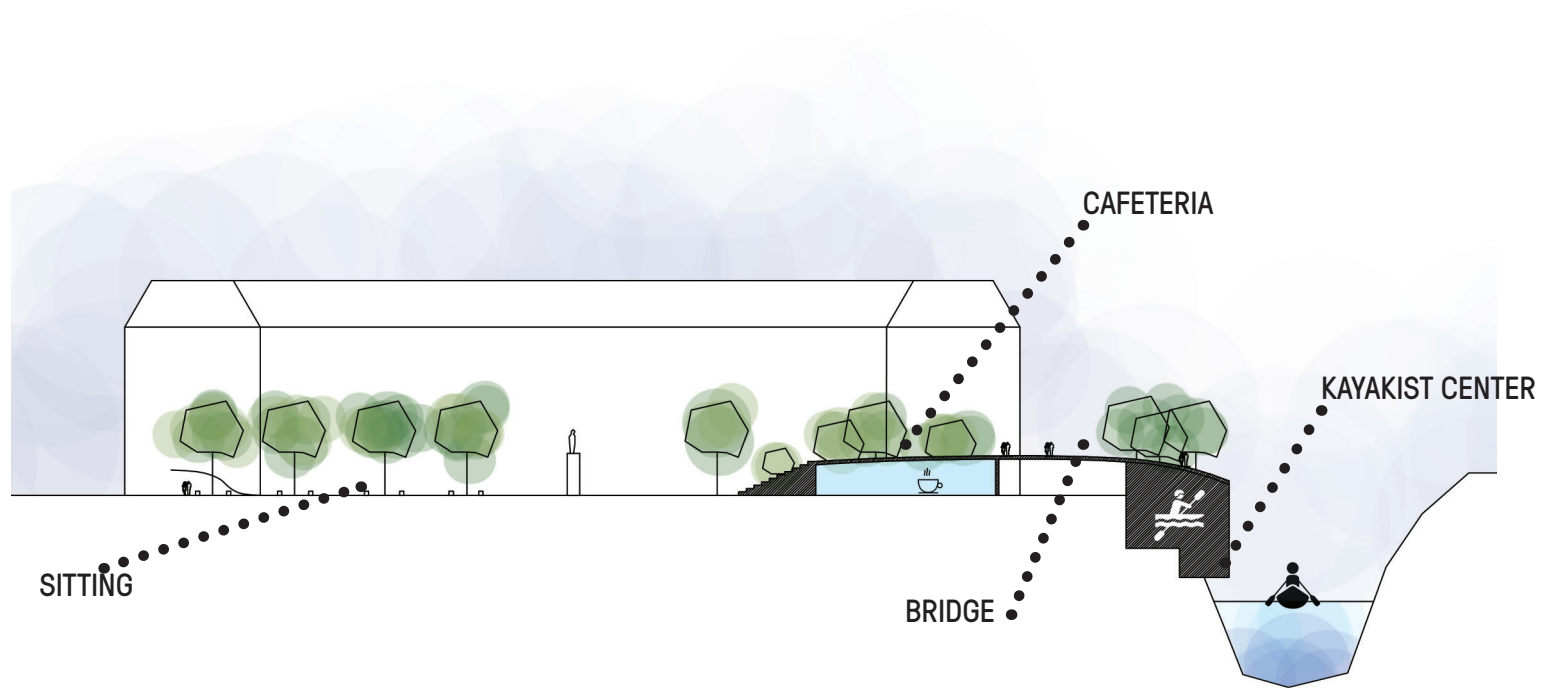

SECTION

